

QUBE 2

The compact design and linear balance of volumes make this wood-burning stove truly unique. The Majolica cladding is available in Bianco Antico, Ardesia, Rosso Lava, Giallo Acceso and Sahara. Its style enriches and enhances its minimalist and geometric design forms.



GENERAL FEATURES

- Heating: Multifuoco System® with 4 power levels, optional. Hot ductable air / Natural convection
- Front ventilation: adjustable vent
- Cladding: majolica
- One-piece firebox: steel
- Firebox: Aluker®
- Flue gas deflector / Brazier: Aluker® / cast iron
- Door / Handle: cast iron with ceramic glass resistant to 750°C / coated steel that can be opened with detachable handle
- Removable ash pan: yes
- Standard flue outlet position: top
- Primary and secondary air: adjustable
- Pre-determined tertiary air: pre-heated
- Glass cleaning: continuous air flow
- Ash vacuum cleaner: optional
- Installation: wall - corner
- Wide view of the fire: yes

TECHNICAL DETAILS

- Energy efficiency class A
- Rated output max kW 9,0
- Rated thermal efficiency power % 80,5
- Rated consumption max kg/h 2,7
- Weight kg 205
- Standard flue outlet Ø cm 15
- Model QUBE 2

COVERS

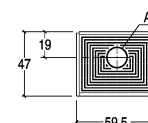
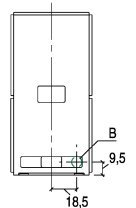
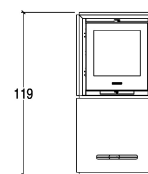
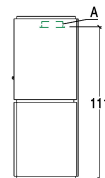

A	B
15 cm	7,5 cm